

# PLAN URBANISTIC DE DETALIU

## - SOS. SALAJ NR.383A SECTOR 5, BUCURESTI nr. cadastral 235903

BILANT		
	mp	%
Steren =	2983,0	
Sconstruita	1057,13	35,44
Ssp. verde	900,00	30,17
Scirculatii	1025,87	34,39
<b>TOTAL</b>	<b>2983,00</b>	<b>100%</b>

Hmax. = 23,00m la atic  
**Sdesfasurata 7450,00**  
 \* Locuinta colectiva cu comert la parter spre strada  
 \* Numar spatii comerciale 3buc.  
 - Suprf. utila 592,80mp

- PROUNERI REGLEMENTARI**
- EDIFICABIL MAXIM DE IMPLEMENTARE PROPUIS - LOCUINTA COLECTIVA
  - COMERT/ SERVICII LA PARTERUL BLOCULUI
  - SPATIU VERDE IN INCINTA
  - PLANTATIE DE ALINIAMENT
  - CAROSABIL PROPUIS
  - ACCES AUTO
  - ACCES PIETONAL
  - TEREN EXPROPRIAT PENTRU CAUZA DE UTILITATE PUBLICA cf. aviz SPU - RLU PUZS



**INDICATORI URBANISTICI**

	conf. P.U.D.	conf. P.U.G.
POT propus	35,45%	60%
CUT propus	2,5	2,5
RH propus	Stehnic+P+6E	
Hmax. la atic	23,00m	

- LEGENDA TOPOGRAFICA**
- limita proprietate
  - gard
  - sosea/trotuar
  - taluz sus
  - punct cotat
  - curba de nivel principala

Coordonate puncte contur NC 235903			Coordonate puncte contur zona M3 conform PUG			Coordonate puncte contur zona VS conform PUG		
Nr. Pct.	X [m]	Y [m]	Nr. Pct.	X [m]	Y [m]	Nr. Pct.	X [m]	Y [m]
1	321277.388	584589.325	7	321257.684	584621.758	2	321252.459	584630.356
2	321252.459	584589.325	8	321231.001	584617.319	3	321227.388	584589.325
3	321199.253	584589.325				4	321227.388	584589.325
4	321207.357	584584.849				5	321220.525	584593.430
5	321220.525	584584.849				6	321207.357	584584.849
6	321224.368	584557.130						

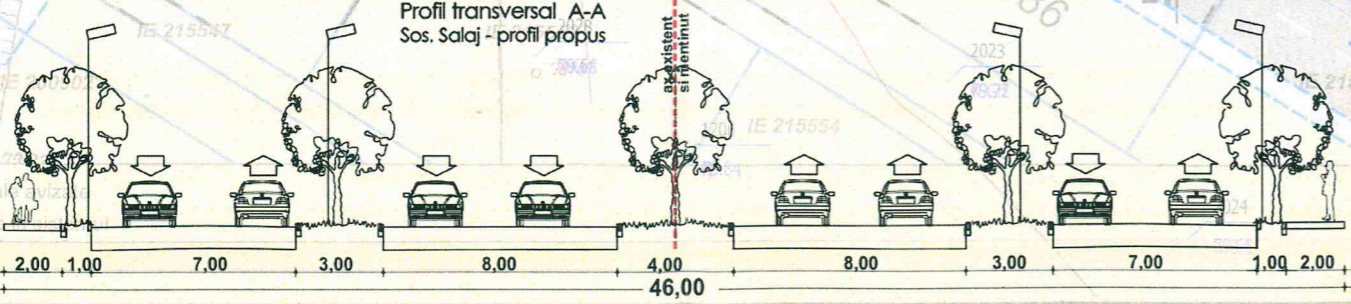
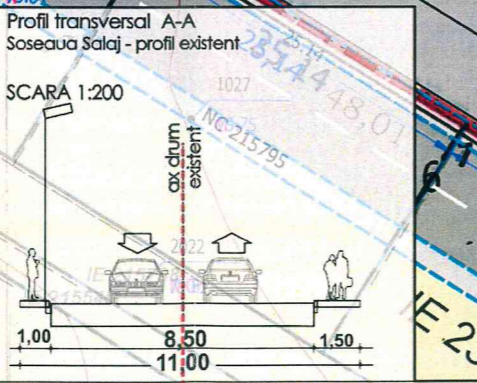
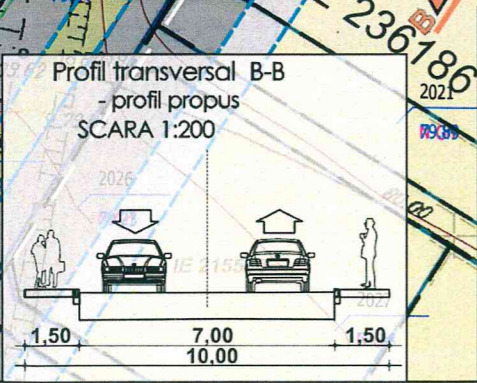
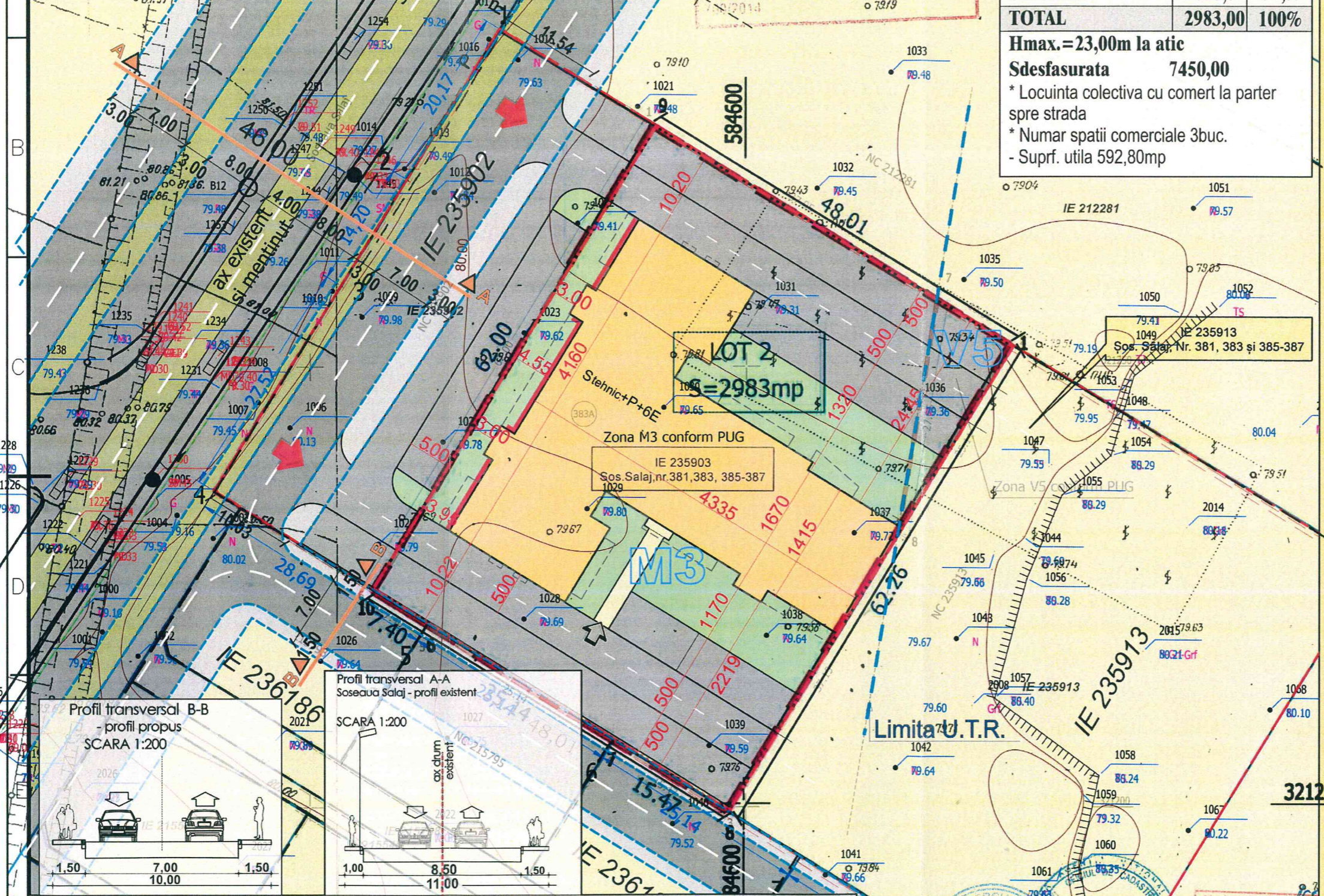

Proiectant General: **S.C. SDH Architecture S.R.L.**  
 str. Temisana nr.19, Bucuresti  
 J40/3174/2008 - CUI 23353656  
 tel: 0744838406

Specialitatea: **URBANISM**

Sef proiect: Urb. Daniela Glinischi

Proiectat: Urb. Daniela Glinischi

Beneficiar: **S.C. SIMEDO CONSTRUCT S.A.**

Denumire proiect: **PUD CONSTRUIRE LOCUINTA COLECTIVA SOS. SALAJ NR.383A**

PR. NR. **U05/2019**

**REGLEMENTARI URBANISTICE ETAPA 2**

Scara: **1/ 500**

Faza PUD

**PI. 04**